

Figure 210. Driver Seat Assembly (Sheet 1 of 2)

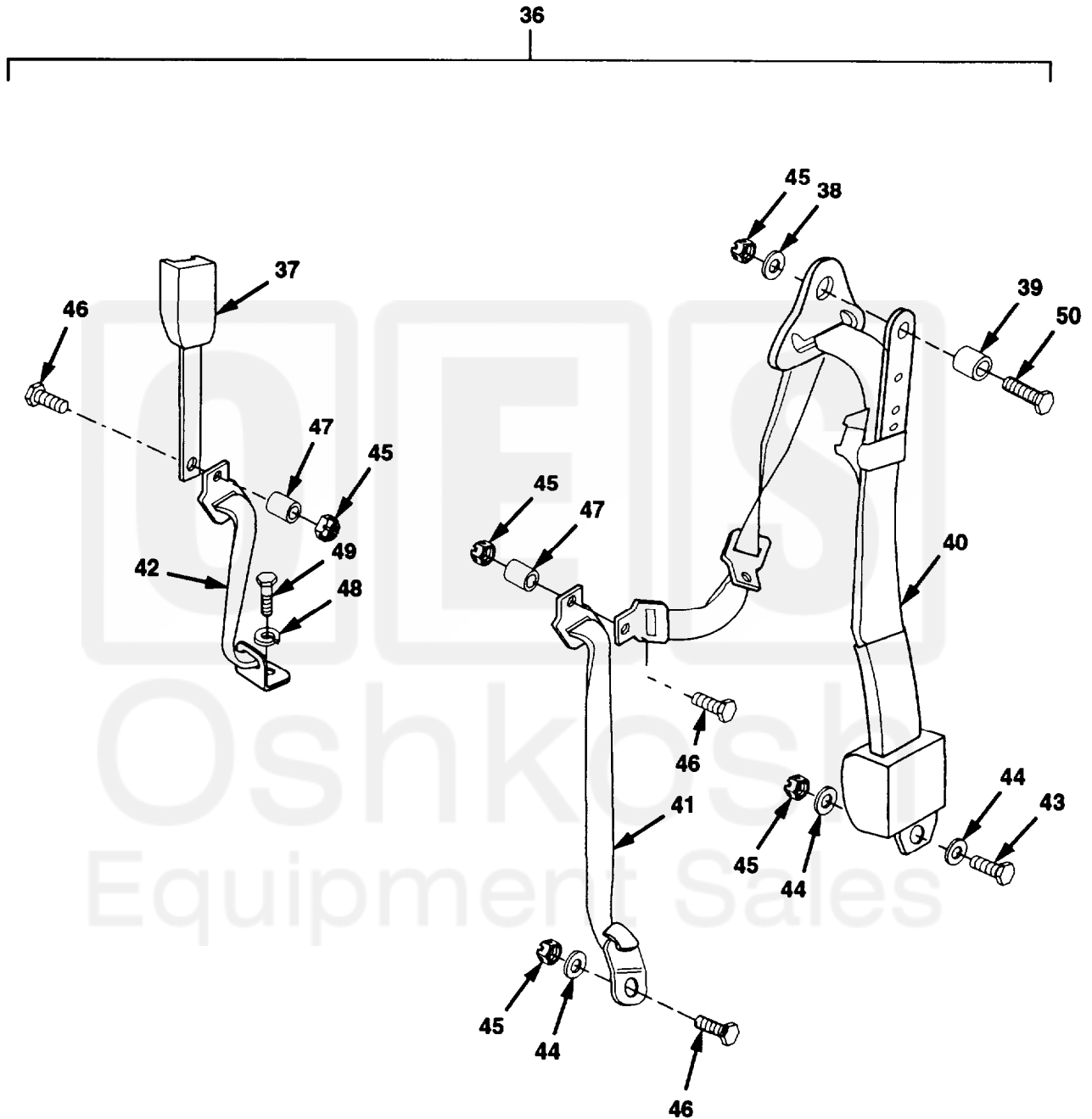

Figure 210. Driver Seat Assembly (Sheet 2 of 2)

## Section II. REPAIR PARTS LIST

(1) ILLUSTRATION		(2)	(3)	(4)	(5)	(6)	(7)	(8)
(a) FIG NO.	(b) ITEM NO.	SMR CODE	NATIONAL STOCK NUMBER	CAGE	PART NUMBER	DESCRIPTION	QTY	INC IN UNIT
						USABLE ON CODE	UM	UNIT
						GROUP 1806 DRIVER SEAT ASSEMBLY		
210	1	PFOZZ	2540-01-152-7909	13339	840	VISOR, SUN, VEHICLE	EA	2
210	2	PAOZZ	5305-01-084-6067	96906	MS51871-1	SCREW, TAPPING 1/4-20 X 1/2	EA	8
210	3	PB000	2540-01-353-7659	09702	144266	SEAT, DRIVERS	EA	1
210	4	PFOZZ	2540-01-264-2024	09704	130724	.COVER, SEAT, VEHICLE	EA	1
210	5	XAOZZ	- - -	09704	301095	.FRAME, BACK	EA	1
210	6	PAOZZ	5305-00-069-5578	96906	MS90725-94	.SCREW, CAP, HEX 7/16-14 X 2 3/4	EA	2
210	7	PAOZZ	5305-01-375-4273	09704	708202	.SCREW, SHOULDER	EA	2
210	8	PAOZZ	5310-01-342-2559	09704	707568	.NUT, SELF-LOCKING	EA	8
210	9	PAOZZ	5310-01-288-1116	82458	T893R	.NUT, SELF-LOCKING 3/8-16	EA	2
210	10	PFOZZ	5360-01-155-4270	09704	707775	.SPRING, HELICAL, TRSN	EA	1
210	10	PFOZZ	5360-01-155-7424	09704	707776	.SPRING, HELICAL, TRSN	EA	1
210	11	PFOZZ	5365-01-350-3082	09704	707282	.WASHER, CUP	EA	4
210	12	PAOZZ	5310-00-081-4219	96906	MS27183-12	.WASHER, FLAT 5/16	EA	6
210	13	PFOZZ	5340-01-353-6104	09704	101104	.BRACKET, VEHICULAR	EA	1
210	14	PAOZZ	5340-01-433-8942	09704	103516	.BRACKET, STOP	EA	1
210	15	PAOZZ	5310-00-851-2677	96906	MS35691-49	.NUT, LOCK 5/8-11	EA	1
210	16	PAOZZ	5355-01-269-8416	09704	101196	.KNOB	EA	1
210	17	PAOZZ	5305-00-068-0502	96906	MS90725-6	.SCREW, CAP, HEX 1/4-20 X 3/4	EA	2
210	18	PAOZZ	5340-01-367-9489	09704	500342	.STRAP, RETAINING	EA	2
210	19	PFOZZ	2540-01-153-8448	09704	130723	.CUSHION, SEAT, VEH	EA	1
210	20	XAOZZ	- - -	09704	300439	.FRAME, CUSHION	EA	1
210	21	PFOZZ	2510-01-153-8450	09704	707774	.ABSORBER, SHOCK	EA	1
210	22	PAOZZ	- - -	09704	707254	.NUT, HEX	EA	2
210	23	PAOZZ	- - -	09704	707293	.WASHER, LOCK	EA	2
210	24	PFOZZ	5340-01-354-0143	45152	1911890	HANDLE, RECESS	EA	1
210	25	PAOZZ	5310-01-155-1905	45152	115303A	NUT, SELF-LOCKING 5/16-18	EA	4
210	26	PBOZZ	2540-01-354-0589	45152	1843700W	SUPPORT ASSY, SEAT	EA	1
210	27	PAOZZ	5305-01-156-9457	52167	WG0412TB	SCREW, CAP, FLANGED 3/8-16 X 1	EA	6
210	28	PAOZZ	5310-01-151-1036	45152	115307A	NUT, SELF-LOCKING 3/8-16	EA	6
210	29	PAOZZ	5305-01-344-8899	45152	1606140	SCREW, CAP, FLANGED 1/4-20 X 3/4	EA	1
210	30	PFOZZ	5340-01-353-6096	45152	1857800	BRACKET, FOOTREST	EA	1
210	31	MOOZZ	- - -	45152	26947BX-4	MOLDING, QUICKEDGE MAKE FROM PART NUMBER 75000317, CAGE 78175. APPROXIMATELY 4 INCHES LONG.	EA	1

## Section II. REPAIR PARTS LIST

(1) ILLUSTRATION		(2)	(3)	(4)	(5)	(6) DESCRIPTION	(7)	(8)
(a) FIG NO.	(b) ITEM NO.	SMR CODE	NATIONAL STOCK NUMBER	CAGE	PART NUMBER	USABLE ON CODE UM	QTY INC IN UNIT	UNIT
GROUP 1806 DRIVER SEAT ASSEMBLY								
210	32	PAOZZ	5315-01-387-3797	96652	30-16	PIN, HITCH	EA	2
210	33	PFOZZ	4010-01-367-9097	45152	1710040W	CABLE ASSY	EA	2
210	34	PAOZZ	5310-01-346-9445	45152	1600460	NUT, SELF-LOCKING 1/4-20	EA	1
210	35	PAOZZ	5310-00-080-6004	96906	MS27183-14	WASHER, FLAT 3/8	EA	1
210	36	PBOZZ	2540-01-355-6233	29944	F10404	SEAT BELT, 3 PT DRIV	EA	1
210	37	XAOZZ	- - -	29944	A34339	.BUCKLE	EA	1
210	38	PAOZZ	5310-01-367-1804	29944	14219	.WASHER	EA	1
210	39	PFOZZ	3120-01-367-1831	29944	14142	.BUSHING	EA	1
210	40	XAOZZ	- - -	29944	XAF10404	.BELT, RETRACTOR	EA	1
210	41	XAOZZ	- - -	29944	F08497	.BELT, TETHER	EA	1
210	42	XAOZZ	- - -	29944	F08498	.BELT, TETHER	EA	1
210	43	PAOZZ	5305-00-071-1788	80204	B1821BH044C125N	SCREW, CAP, HEX 7/16-14 X 1 1/4	EA	3
210	44	PAOZZ	5310-00-809-4061	96906	MS27183-15	WASHER, FLAT 7/16	EA	3
210	45	PAOZZ	5310-00-241-6659	96906	MS51943-37	NUT, SELF-LOCKING 7/16-14	EA	5
210	46	PAOZZ	5305-00-071-2055	80204	B1821BH044C150N	SCREW, CAP, HEX 7/16-14 X 1 1/2	EA	3
210	47	PAOZZ	5365-01-433-1005	29944	00041	SPACER	EA	2
210	48	PAOZZ	5310-00-209-0965	96906	MS35338-47	WASHER, LOCK 7/16	EA	1
210	49	PAOZZ	5305-00-071-1786	80204	B1821BH044C100N	SCREW, CAP, HEX 7/16-20 X 1	EA	1
210	50	PAOZZ	5305-01-133-8614	45152	2610HX	SCREW, CAP 7/16-14 X 3 1/2	EA	1